

# @lgood



Panic hardware



## 10280

Surface mounted 3 point pushbar bolt.

- Applicable for single doors and pairs of rebated doors when used in conjunction with 10282 pushbar latch (page 37)
- To suit doors 2600mm high and 1060mm wide
- Suitable for timber, aluminium and steel doors
- Reversible mechanism
- Push bar and top vertical rod can be easily cut to length to suit various door heights and widths
- Can be operated from outside by optional 10288A external access device (page 37)
- Independently tested to BS EN 1125  
[375111322A](#)
- CE marked 0425-CPD-1825
- Incorporated in successful fire tests and assessed to BS EN 1634-1 and BS 476 Pt 22 up to 60 minutes on timber doors

**Finishes:** SS (XX10280SS)

Silver (XX10280)

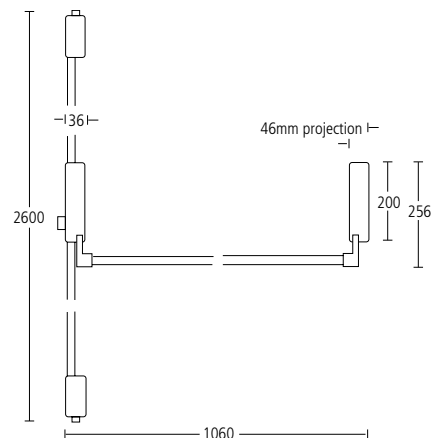



## 10282

Surface mounted pushbar latch.

- Applicable for single doors and pairs of rebated doors when used in conjunction with 10280 Touchbar bolt (page 36)
- To suit doors 1060mm wide
- Suitable for timber, aluminium and steel doors
- Reversible mechanism
- Push bar can be easily cut to length to suit various door heights and widths
- Can be operated from outside by optional 10288A external access device (page 37)
- Independently tested to BS EN 1125  
**375111322A**
- CE marked 0425-CPD-1825
- Incorporated in successful fire tests and assessed to BS EN 1634-1 and BS 476 Pt 22 up to 60 minutes on timber doors

**Finishes:** SS (XX10282SS)

Silver (XX10282)

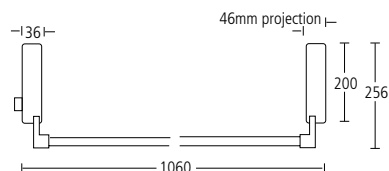

## 30057

Surface mounted 'Push bar to open' sign.

**Finish:** XX



## 10288A

External access device with half pair lever handle and euro profile escutcheon.

- For use with 10280 and 10282 pushbar devices
- Lever handle is engaged or disengaged by operating the cylinder
- Non-handed
- XX7420ND cylinder must be specified separately
- Can be integrated into a master key suite

**Finish:** SS (XX10288A)

## 7420ND

Single euro profile cylinder for use with 10288A on doors up to 51mm thick.

**Finish:** XX



## 9320

Surface mounted 3 point Touchbar bolt.

- Applicable for single doors and pairs of rebated doors when used in conjunction with 9325 Touchbar latch (page 105)
- To suit doors up to 2650mm high and 850mm wide
- Suitable for timber, aluminium, steel and PVC doors
- Reversible mechanism
- Can be operated from outside by optional 9326 external access device (page 105)
- Independently tested to BS EN 1125 [377B1422BA](#)
- CE marked
- Incorporated in successful fire tests and assessed to BS EN 1634-1 and BS 476 Pt 22 up to 90 minutes on timber doors
- 10 year guarantee

**Finishes:** SS (XX9320S)  
Silver (XX9320)

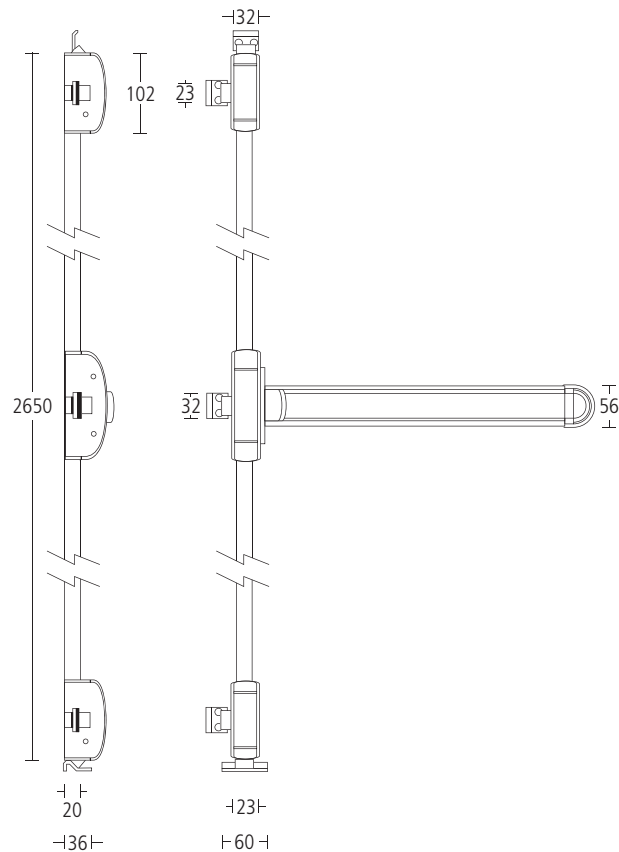



## 9325

Surface mounted single point Touchbar latch.

- Applicable for single doors and pairs of rebated doors when used in conjunction with 9320 Touchbar bolt (page 104)
- To suit doors up to 2650mm high and 850mm wide
- Suitable for timber, aluminium, steel and PVC doors
- Reversible mechanism
- Can be operated from outside by optional 9326 external access device (page 105)
- Independently tested to BS EN 1125  
377B1422BA
- CE marked
- Incorporated in successful fire tests and assessed to BS EN 1634-1 and BS 476 Pt 22 up to 90 minutes on timber doors
- 10 year guarantee

**Finishes:** SS (XX9325S)  
Silver (XX9325)

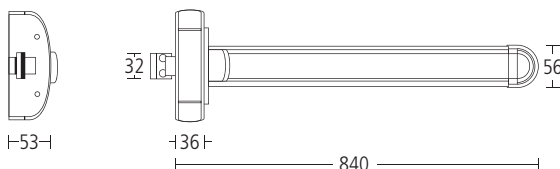

## 9326

External access device with half pair 3502 Modric lever handle.

- For use with 9320 and 9325 Touchbar bolt and latch respectively
- To suit timber doors up to 100mm thick
- Lever handle is engaged or disengaged by operating the cylinder
- Non-handed
- 7420A cylinder must be specified separately
- Can be integrated into a master key suite

**Finishes:** SS (XX9326S)  
Silver (XX9326)

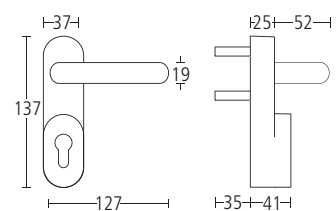

## 9326E

As above but with electronic access control facility.

**Finishes:** SS (XX9326SE)  
Silver (XX9326E)

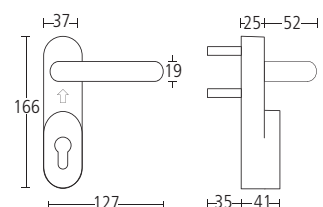



## overseas projects

### **Allgood Worldwide**

297 Euston Road  
London NW1 3AQ  
Telephone: +44 (0)20 7255 9330  
Facsimile: +44 (0)20 7383 7950  
E-mail: [info@allgoodww.com](mailto:info@allgoodww.com)  
Website: [www.allgoodww.com](http://www.allgoodww.com)

## uk projects

### **Allgood plc**

297 Euston Road  
London NW1 3AQ  
Telephone: 020 7387 9951  
Facsimile: 020 7380 1232  
E-mail: [info@allgood.co.uk](mailto:info@allgood.co.uk)  
Website: [www.allgood.co.uk](http://www.allgood.co.uk)

63-83 Brearley Street  
Birmingham B19 3NT  
Telephone: 0121 359 4415  
Facsimile: 0121 359 5832  
E-mail: [info@allgood.co.uk](mailto:info@allgood.co.uk)  
Website: [www.allgood.co.uk](http://www.allgood.co.uk)

28 Queen Street  
Manchester M2 5HX  
Telephone: 0161 834 6717  
Facsimile: 0161 834 6839  
E-mail: [info@allgood.co.uk](mailto:info@allgood.co.uk)  
Website: [www.allgood.co.uk](http://www.allgood.co.uk)

The Wright Business Centre  
1 Lonmay Road, Glasgow G33 4EL  
Telephone: 0141 773 6298  
Facsimile: 0141 771 9569  
E-mail: [info@allgood.co.uk](mailto:info@allgood.co.uk)  
Website: [www.allgood.co.uk](http://www.allgood.co.uk)